

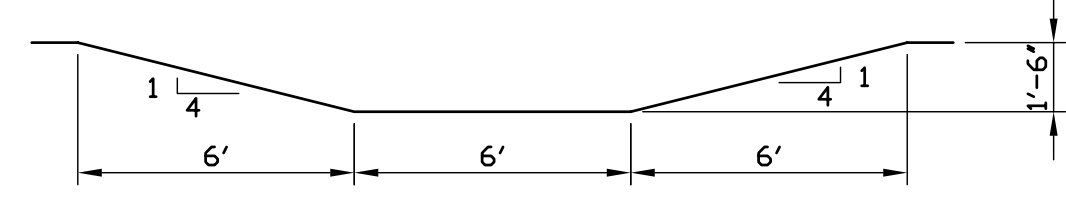

**STORM DRAINAGE NOTES**  
1. ENTRY ROOF TO BE DRAINED BY 36 L.F. OF 4" PVC PIPE @ 1.00% MIN. SLOPE.  
2. CONTRACTOR SHALL ESTABLISH A MINIMUM OF 24" OF COVER TO FINISHED GRADES FROM THE TOP OF THE STORM SEWER PIPE. MOUND BACKFILL AS NECESSARY AND SLOPE AWAY AT A 6:1 TO SURROUNDING GRADES.



**DRAINAGE SWALE**

**2 CROSS-SECTION**  
SCALE: NTS

**EARTHWORK QUANTITIES:** (Does Not Include Borrow Area)

|   |                    |  |  |
|---|--------------------|--|--|
| <b>LOT #17 QUANTITIES:</b>  |                    | <b>OVERALL QUANTITIES:</b>   |  |
| GENERAL EARTH CUT:  | 9,932 CUBIC YARDS  | THIS ACCOUNTS FOR AN ASSUMED 8" OF TOP SOIL AND +/- 15% SHRINKAGE.                             |  |
| GENERAL EARTH FILL:   | 13,308 CUBIC YARDS | ACTUAL QUANTITIES TO BE FIELD VERIFIED.  |  |
| TOPSOIL REMOVAL:  | 14,529 CUBIC YARDS | UNDERCUT ASSUMED TO BE 2.5' AVERAGE.   |  |
| UNDERCUT & REPLACE:   | 20,437 CUBIC YARDS | SOME UNDERCUT AND EARTHCUT MAY BE USED AS EARTHFILL IF PROPERLY DRIED. SEE GEOTECHNICAL REPORT |  |
| FILL MATERIAL REQ'D:<br>(13,308+20,437) 1.15 = 38,807 CUBIC YARDS |                    |  |  |
| UNDERCUT & EARTHCUT TO BE REMOVED:<br>30,369 CUBIC YARDS          |                    |  |  |

**SITE LEGEND**

|  |   |  |                              |
|--|---|--|------------------------------|
|  | 134 EXISTING MINOR CONTOUR              |  | PRECAST HEADWALL - SEE 1/GP2 |
|  | EXISTING MAJOR CONTOUR                  |  | AREA DRAIN - SEE 5/GP2       |
|  | 134 FINISH CONTOUR                      |  | CURB BREAK - SEE 3/GP2       |
|  | 134.50 FINISH SPOT ELEVATION - SEE GP-2 |  |                              |
|  | FLARED END SECTION - SEE 2/GP2          |  |                              |

**EROSION CONTROL LEGEND**

|  |    |   |
|--|----|---|
|  | CE | TEMP. CONST. ENTRANCE<br>SEE 4/GP3                              |
|  | IP | INLET PROTECTION - SEE 2/GP3                                    |
|  | ST | TEMP. SEDIMENT TRAP - SEE 3/GP3                                 |
|  | SF | SILT FENCE - SEE 6/GP2  |
|  |    | *GOLF COURSE* TYPE<br>BERMS MAX. SLOPE 3:1<br>(MUST BE MOWABLE) |

See sheet GP-2 and sheet GP-3  
for further Grading and Drainage  
Information.  
(Point Elevations)

AREA DISTURBED:  
APPROX. 588,422 SQ. FT. OR 13.5 ACRES

BORROW AREA:  
APPROX. 120,520 SQ. FT. OR 2.8 ACRES

**GENERAL NOTES**

- ROOF DRAIN PIPING: HANCOR HI-Q SUR-LOK 2.0 SMOOTH INTERIOR/ CORRUGATED EXTERIOR POLYETHYLENE PIPE OR EQUAL. VERIFY W/ REAL ESTATE DIRECTOR
- ALL WORK SHALL BE IN ACCORDANCE WITH PRINCE GEORGE COUNTY STANDARD SPECIFICATIONS.
- LOCATION OF WETLANDS SCALED FROM HYDROLOGY AND EROSION CONTROL PLAN BY TIMMONS ENGINEERING, SHEET #2, JOB NUMBER 18055, REVISION 12/26/99, AND SHOULD BE CONSIDERED APPROXIMATE. DO NOT DISTURB EXISTING WETLANDS. LOCATION OF WETLANDS SHALL BE VERIFIED BY A LOCAL EXPERT PRIOR TO LAND DISTURBANCE. STAKE AND PROTECT WETLANDS DURING CONSTRUCTION.
- SOURCE SHEET #2 JOB #18055, SOUTHPOINT BUSINESS PARK BY THOMAS ENGINEERING, DATED 2-26-99.

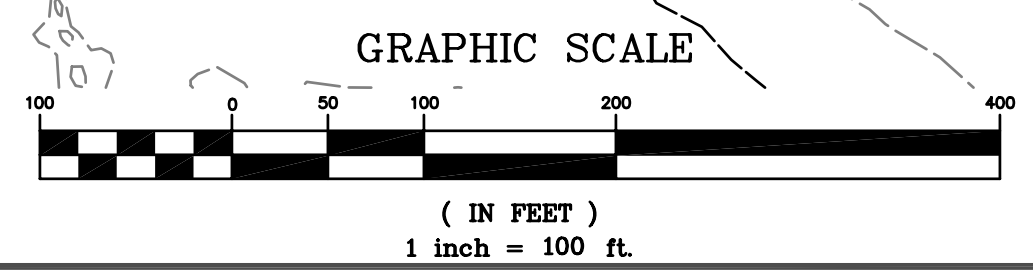
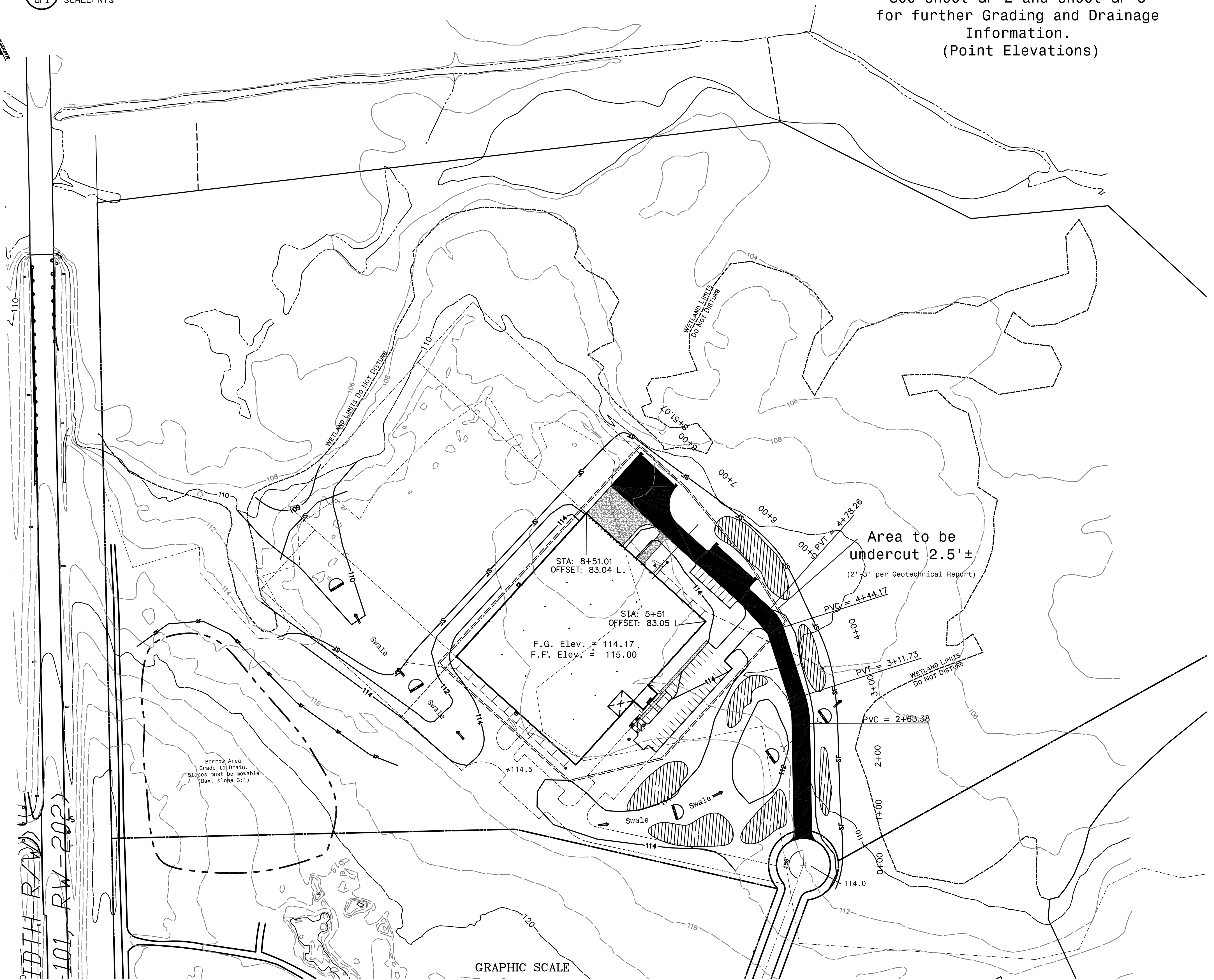

See Sheet GP-3 For Project  
Information, Site Notes, Erosion  
Control Notes and Narrative