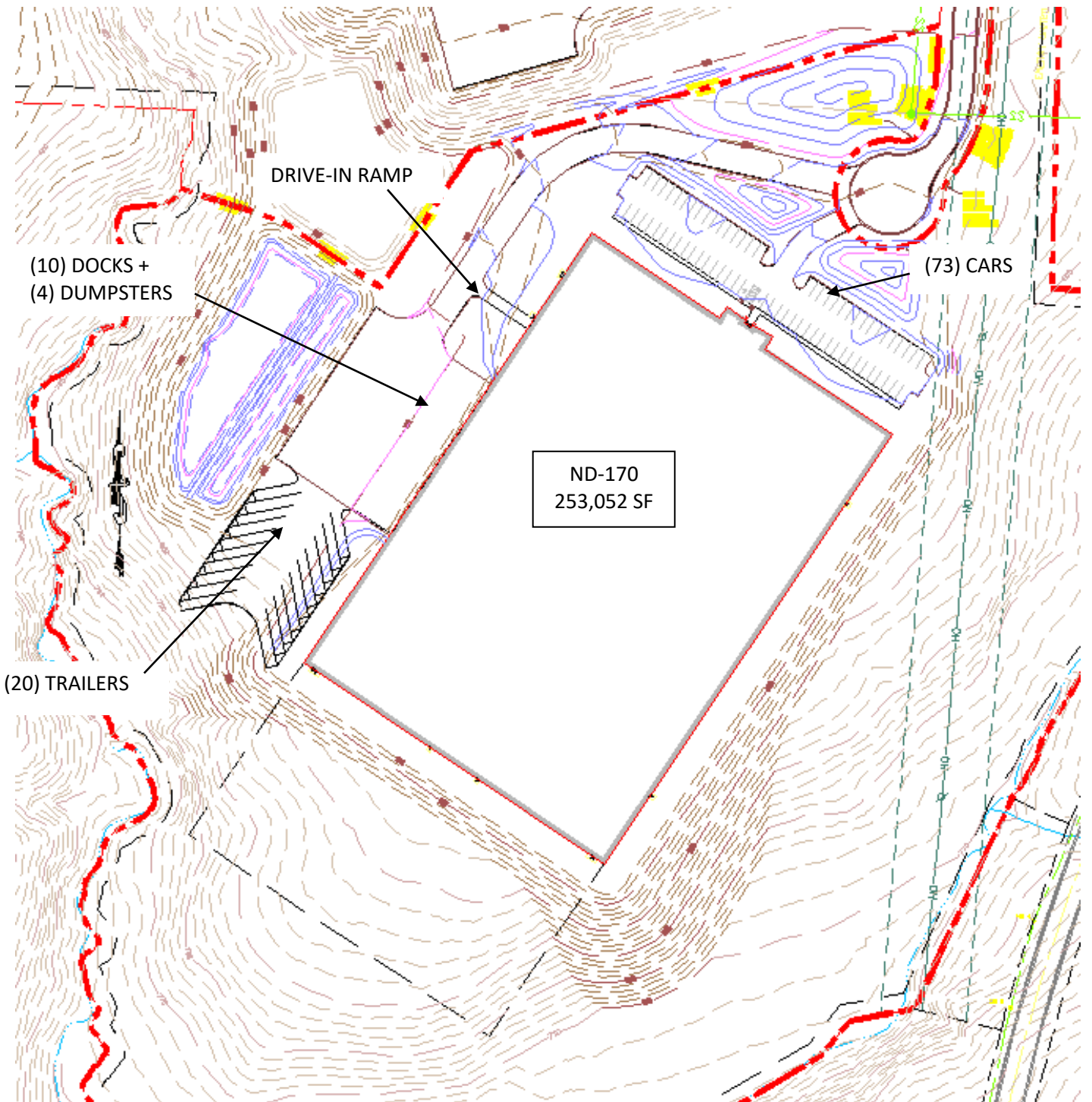

EXHIBIT A – SITE PLAN



Lying and being situate in Davie County, NC, and being more particularly described as follows:

Being Lot(s) 12 and containing 30.826 ± acres, as shown on a "Plat" entitled "Boundary Survey and Division for: SouthPoint Business Park" recorded in Plat Book 12, Page 378, in the Office of the Register of Deeds of Davie County, NC, which plat was prepared by Allied Associates PA dated June 19, 2017, job number PA170606, and which plat is incorporated herein by reference.